

TECHNICAL RIDER

PILAR BOX

Pilar Box is a multipurpose performance space of 15 by 15 square meters on the VUB campus.

Capacity:

Standing: 300

Seated: 90

Specifications:

Walls: white

Curtains: black (black box)

Floor: grey

Stage: black

INNER Dimensions (with ventilation): Length: 14m / Width: 14m / Height: 8.36m

Max Truss height: 6,40m

STAGE

Depth: 4m

Width: +/- 14m

Max. Load: 700 kg/ m²

Height to main floor: 0,61m

The stage is standard in the Pilar BOX. An additional cost of €180 will be charged to the tenant for the dismantling of the stage.

TRIBUNE / SEATS

Number of seats: 90 people (stand with level difference and retractable)

Depth: 2,5m

Width: 7,41m

Height: 2,7m

Row: #9 - 10 seats each

Row depth: 0,92m

Last row depth: 1,27m

Row height: 0,29m

SOUND SYSTEM

FIXED SPEAKERS F.O.H.

Nexo 6 top M1220-I

Nexo 2 bass RS18-PI

Nexo 1 amplifier NXAMP4X4C 4 channels + DANTE ready

SOUND MIXER

Stage Rack Allen & Heath DT168 WITH DANTE CARD

Allen & Heath SQ5 WITH DANTE CARD

WE WORK THROUGH DANTE NETWORK !!

IF YOU NEED ANALOG CONNECTION TO THE AMPLIFIER, BRING YOUR OWN MULTICABLE THAT IS LONG ENOUGH TO GET TO THE AMPLIFIERS BACKSTAGE.

Technical support for light and/or sound is necessary and to be provided by the tenant.

LIGHT FIXTURES

All our light is LED.

THE STANDARD LIGHT @ THE GRID → NOT CHANGEABLE!

6 x FRESNEL = ETC S4 Tungsten HD HD SERIE 2, FRESNEL Adapter MODUS STUDIO

2 x PROFILE = ETC S4 Tungsten HD HD SERIE 2, 25-50 Zoom Lens Tube Black Adapter, MODUS STUDIO

4 x APC = ETC Color source CYC, MODE 1

5 x PAR = SHOWTEC M800 TOUR, MODE 16 BIT

2 x BLINDER, BRITEQ

LIGHT TABLE

GrandMa 3 Compact RUNNING ON SOFTWARE 2 AND SOFTWARE 3

ARTNET CONNECTION!

Connection available at Cour, Jardin, Mid Back and Control room

If you want to use another table, be sure how to connect your table with Artnet.

We don't have dimmers for conventional light. There is a power supplier in our backstage that you can use. In that case, bring your own dimrack. Please check 'available power' of this TF.

TOCAN 800

Pilar has a mobile aerial platform that can be used if you are licensed. **USE AT OWN RESPONSIBILITY AND RISK.** By signing a rental contract with Pilar you release Pilar from all responsibilities associated with using the Tocan 800. We ensure that it is inspected quarterly.

VIDEO

Digital projection: HIGHlite Laser II 13,000 Lumens
Contrast Ratio: 2,000:1 (10,000:1 Dynamic) 1920 x 1200 pixels native display
Lens Highlite 1.45 - 1.74 : 1
Connection: VGA, HDMI in/out, DP, BNC + AV link over IP

PROJECTION SCREEN

1 Professional projection screen:
White, front projection suspended in the ladder truss to the wall.
Width: 9m, height: 5m
MAX PICTURE SIZE:
Width: 8,57m, height: 4,70m.
MIN.PICTURE SIZE:
Width: 7,5m, height: 3,4m.

RIGGING

6 square trusses and 2 ladder trusses, 1 is reserved for the black back curtain and projection screen.
Can be operated individually. Operation is located at stage, cour cote in a closed cupboard.
Track 1, 2, 3, 4, 5, 6, with power.
Truss ladder track for curtain black box and projection screen. Can also be used for back drop.
Truss 3 is used for audio and cannot be easy operated.
Max draw height for light in the hood is 6.40m.
Track 1, 2, 3, 4, 5, 6 is pre-wired for light.
No standard clogging or legs provided.

AVAILABLE POWER

Cour on stage 2 x 32A (→ 1 for the stage rack) 1 x 16A, 240V
Center of the hall: 32A
Rear of the hall: 32A (Center under seats/ TRIBUNE)
1 x 16A, 240V (Center)
2 x 16A, 240V (Cour & Jardin)
1 x 16A, 240V (Jardin)
Backstage 2 x 32A
On the back wall: 2 x 16A / 240V (Cour & Jardin)

Patch panel backstage

Fix power for grid 1 x 63A → 2 x 32A → Divided in 6 different lines of 8 power connections (patch panel for light in the grid).

Fix power backstage 1x 63A → Divided in 4 x 32A 3 phase → Could be used for extensional dimrack.

IN HOUSE EQUIPMENT

SOUND

20 x XLR CABLES (3m, 5m, 10m)

4 x Mic STANDS (2 x MEDIUM + 2 x SMALL)

3 Mic's SM58

2 x DI MONO

4 x CINCH – CINCH MONO

5 x CINCH – CINCH STERIO

2 x CINCH MONO – JACK MONO

1 x CINCH STERIO – JACK STEREO

10 x JACK MONO- JACK MONO

1 x JACK STEREO – JACK STEREO

8 x JACK STEREO – XLR M

8 x JACK STEREO – XLR F

TRANSMISSIONS (WITHOUT CABLE)

4 x JACK – XLR F

2 x JACK – XLR M

2 x XLR M – XLR M

2 x XLR F – XLR F

2 x XLR M – CINCH F

2 x XLR M – CINCH M

2 x MACKI, THUMP 15

2 x MACKI TRIPOT

POWER & LIGHT

15 x POWER CABLES (5m,10m,15m)

5 x POWER DIVIDERS (POWER DISTRIBUTION BOX)

2 x SINGLE DIMMER SHOWTEC

15 x DMX CABLES (3m, 5m, 10m, 15m)

VIDEO

1 x UTP – HDMI CONVERTER

1 x HDMI – UTP CONVERTER

5 X UTP CABLES (5m, 10m)
2 x HDMI CABLE (5m)

BACK STAGE DRESSING ROOMS

Quantity: 2

These are located on the first floor. The dressing rooms can be reached via the stair through the backstage. **NO ELEVATOR!**

Backstage 1: Width: 4.3m Length: 3.6m

Backstage 2: Width: 2.90m Length: 5.30m. Access to the terrace.

Tables & seats are present in every backstage room.

Showers & toilets: 2

LOADING - UNLOADING

Loading and unloading through the loading platform backstage or through the elevator at the parking lot.

Loading platform - same level as stage height (0,61m).

Dimensions of the entrance door to the stage:

Width: 1.66m - Height: 2.12m - Diagonal: 2.74m

Dimensions public entrance door:

Width: 2.35m - Height: 2.12m - Diagonal: 3.15m

WIFI

Please ask our production officer for logins for VUB Guests accounts. No hard wire connection available unless on stage. **ASK FOR MORE SPECIFICATIONS IF YOU NEED A HARD WIRE CONNECTION!**

SOUND LIMIT

Max 100 dBA Leq 60 min & 115 dBC Leq 60 min at FOH.

We have 10Eazy measuring software.

Please work with us on this one, we are legally responsible. Any violation of this rule might cause us to lose our license.

CONTACT:

Production officer:

Bjorne Baeten

Bjorne.Baeten@vub.be

+32 (0)2 629 23 26

Audiovisual technician:

Carolien Den Hond

Carolien.den.hond@vub.be

+32(0)477965732

Pilar

Address: Pleinlaan 2, 1050 Elsene

Access: Triomflaan, VUB ingang 6, 1050 Elsene



SITUATION 1

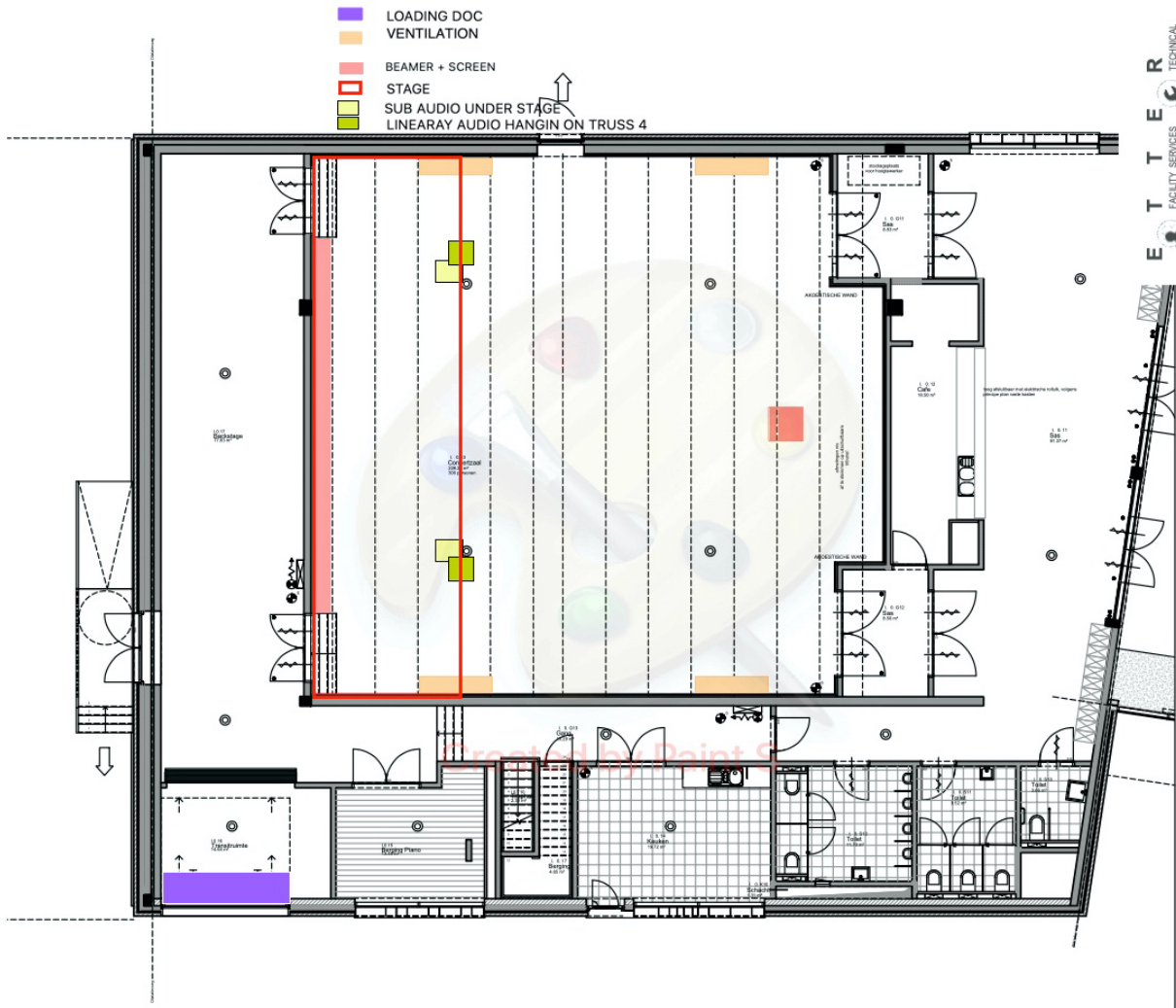

SITUATION 2



RIGGING



BASIC LIGHT RENTAL



BASIC LIGHT CONCERT

